

State of New York.

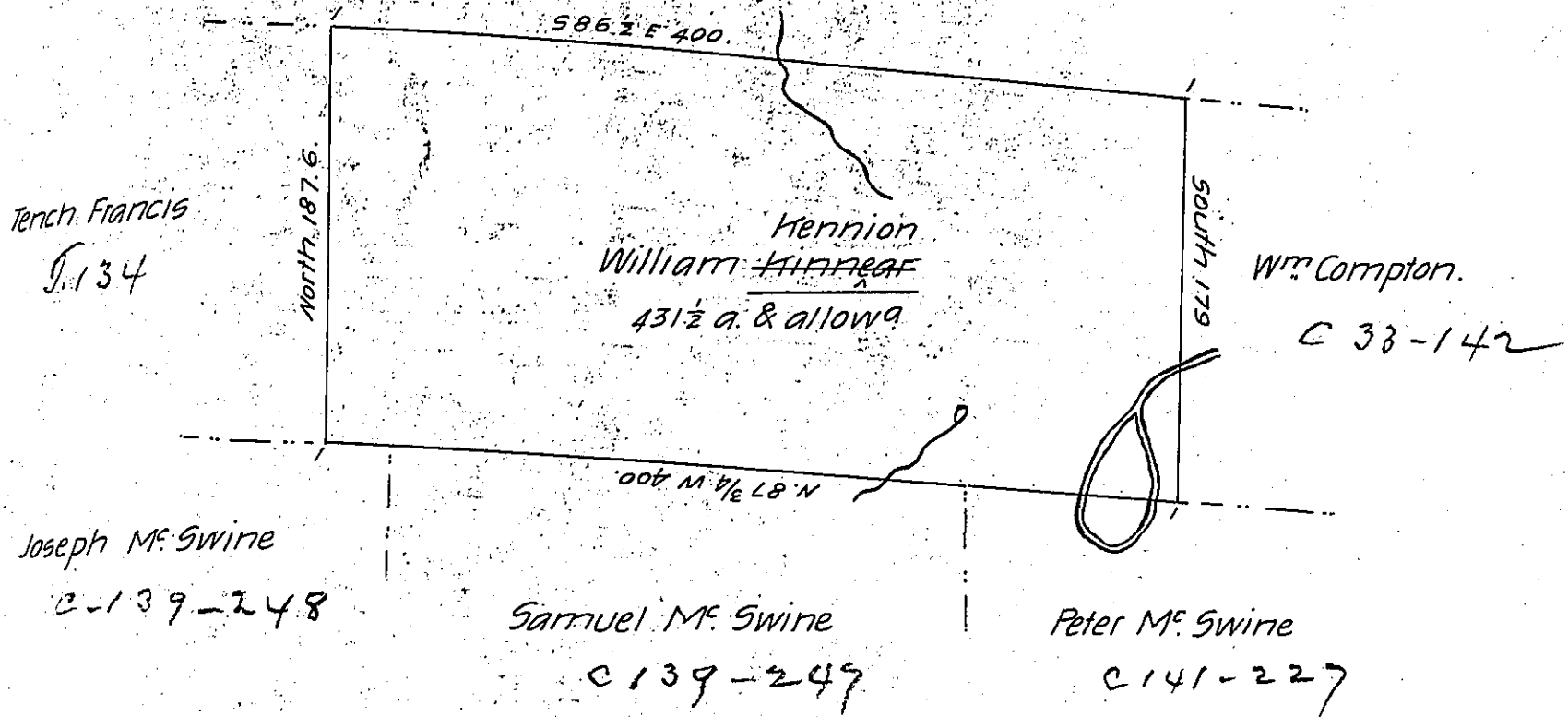

A Draught of a Tract of Land Called _____ Situate adjoining land
of William Compton and others in the County of Luzerne Surveyed on the
15th day of September 1787 for William ~~Hennion~~ Hennion
by virtue of a warrant
dated the 26th day of July 1787 Containing four hundred and thirty one
acres and a half and allowa of Six P. Ct for Floods &c.

by

Wm Gray D.S.

To John Lukens Esqr.

Surv. Genl

IN TESTIMONY that the above is a copy of the original remaining on file in
the Department of Internal Affairs of Pennsylvania, made
conformably to an Act of Assembly approved the 16th day of
February, 1833, I have hereunto set my Hand and caused
the Seal of said Department to be affixed at Harrisburg,
this twenty seventh day of September 1905.

Loac P. Swine
Secretary of Internal Affairs.